

# LRA-EXTX Door Chime Extender

## Owner's Manual

*This device complies with Part 15 of the FCC rules, Operation of this device is subject to the following conditions: 1. This device may not cause harmful interference. 2. This device must accept any interference, including interference that may cause unde-sired operation.*

### Introduction

The LRA-EXTX (transmitter) connects to a standard wired doorbell. When the wired push button outside is pressed, the doorbell dings as usual, and the LRA-EXTX transmitter is triggered and sends a radio signal to a compatible LRA receiver for notification (strobe, chime sounds, etc.).

### Important Notes

- The LRA-EXTX chime extender can work with both the front door & "second" door of your wired doorbell.
- The transmitter only works with standard wired doorbells that play a "ding" or "ding-dong" sound. It does not work with intercom or video doorbells.
- The transmitter works 9V-18V AC wired door chimes.
- Powered by a CR123A battery that should last up to 2 years prior to replacement.
- Dimensions are 2-1/4" L x 2-1/4" W x 1/2" D.
- Must be used in conjunction with a LRA receivers such as the LRA-DCRXA-L or the LRA-DCRXS-L.

### Battery Installation

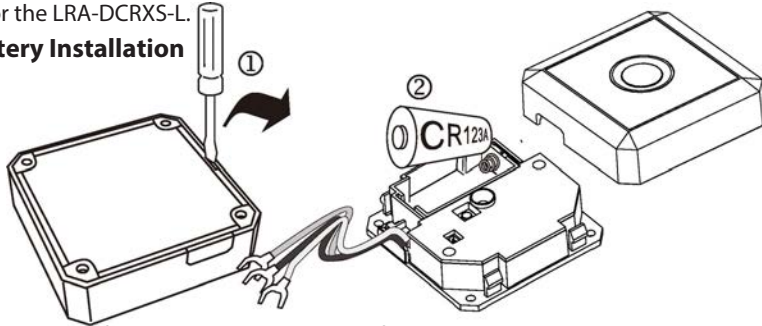

1. Open the front cover using a small flat-head screw driver (see #1 above).
2. Insert included CR123A battery into the battery compartment (see #2 above). Ensure to remove the plastic wrap around the battery prior to installing.
3. Press the "front door" or "back door" button. You should see a red LED to show the transmitter is working correctly.

### Programming the LRA-EXTX to Your Wired Doorbell

The LRA-EXTX transmitter wires directly into the wired doorbell/door chime inside your home (typically hanging in the foyer). We recommend you pair/program the LRA-EXTX to a compatible LRA receiver prior to wiring & mounting the transmitter. LRA receivers are multi-zoned, meaning each transmitter is paired to a zone with each zone having a distinct melody assigned to it. If your wired doorbell is connected to two doors (front door and second door), then each door (outdoor wired push button) will correspond to a zone on the LRA receiver. The button labeled "front door" on the LRA-EXTX will wire

### Programming the LRA-EXTX to Your Wired Doorbell (cont.)

to the front doorbell button on your existing wired doorbell & the "back door" button on the LRA-EXTX will wire to the back doorbell button on your existing wired doorbell in your home. If the existing wired doorbell in your home does not use or have a "back" or "second" doorbell button, you do not have to program the "back door" button.

Each LRA receiver will come with instructions on programming/pairing that receiver to a transmitter as each are slightly different.

### The instructions below outline how to pair the transmitter to the LRA-DCRXS

- Ensure the battery is installed in the LRA-EXTX-L transmitter & the compatible receiver is powered on. Ensure the plastic wrap is removed from battery prior to inserting into transmitter.
- Open the front cover of the receiver. Press & hold the zone selector button • for approximately three seconds until you see "Zone 1" flashing on the receiver. When it starts to flash, release the zone selector button. The flashing zone signifies that this zone is in programming/pairing mode.
- If you are programming the "front door" button on the LRA-EXTX transmitter to this zone, move to the next step. If you are programming the LRA-EXTX transmitter to a different zone, press the zone selector button • again to scroll to the desired zone.
- Next you will select the desired melody for that zone by scrolling through the melodies using the melody selector button 🎵 (located next to zone selector button).
- Once you hear the desired melody, stop pressing the melody selector button 🎵.
- Press the "front door" button on the LRA-EXTX transmitter.
- A red LED should flash on the transmitter after you press the button. When the transmitter has paired to the receiver, the strobe on the receiver will flash once, and the next zone's LED will start blinking.
- If you would like to program the "back door button," follow this step. If not, skip to the next step. Using the 🎵 button, scroll to the desired melody you desire for this zone. Once you hear the desired melody, press the "back door button" on the transmitter to pair the transmitter to this zone
- To exit programming/pairing mode, scroll past zone four on the receiver using the • zone selector button. After scrolling past zone four, none of the zone lights should be flashing. This shows you are no longer in pairing/ programming mode.

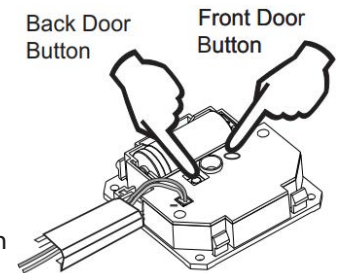

## Test the Programming

After completing the programming steps above, test the programming/pairing prior to mounting the transmitter. Push the "front door" button and/or the "back door" button on the transmitter. You should see a red LED on the transmitter & the receiver should flash and/or play the selected melody (see receivers for mode of operation settings). If there's no red LED on the transmitter, ensure the plastic wrapper is removed from the battery & it's inserted correctly.

## Installing/Mounting the LRA-EXTX to Your Doorbell

The transmitter may be small enough to fit inside your wired doorbell cabinet or you may decide to simply set it on top of your wired door chime cabinet. The instructions below illustrate using the "cable duct." This is not mandatory and is only aesthetic purposes. After wiring the transmitter to your wired doorbell, you can decide the best location to place the transmitter. You can use the double sided tape or mounting screws to mount the transmitter to the wall, hide it in the doorbell cabinet, fix to the side, or simply lay it on top of the doorbell cabinet. **We recommend using the included screws to enable you to easily take it down to change the batteries.**

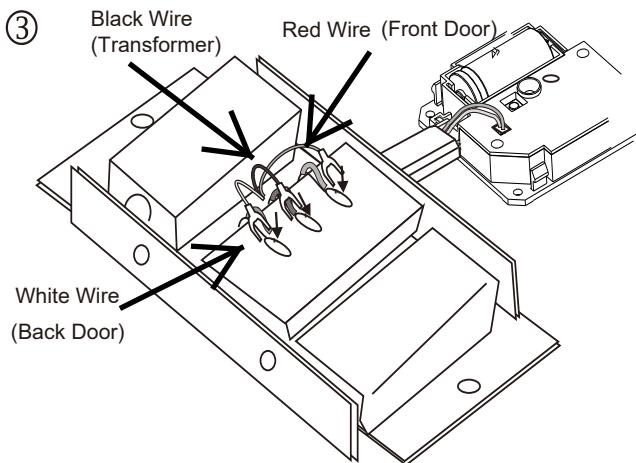
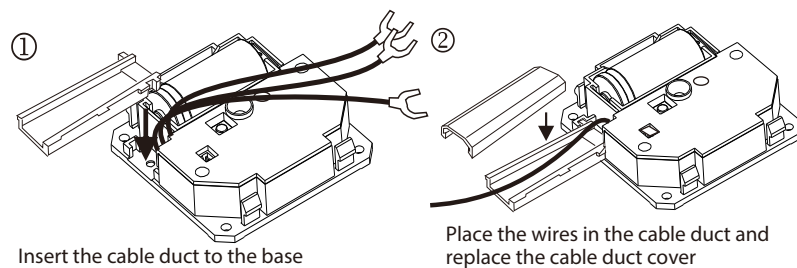

## Wiring the Transmitter to Your Wired Doorbell

*\*If you are not familiar with electrical projects, please hire a certified electrician. Ensure you have no power going to your wired doorbell by turning off the circuit breaker.*

- Connect the red wire from the transmitter to the front door terminal screw on your wired doorbell (see #3 above).
- Connect the black wire from the transmitter to the second or back door terminal screw on your wired doorbell. If you are not using a second door you can go ahead and connect it or wrap the connector of the wire in electrical tape to prevent interference.
- Connect the black wire from the transmitter to the "transformer," or "common" terminal screw on your wired doorbell.

## Wiring the Transmitter to Your Wired Doorbell (cont.)

- Test the installation by pressing the outdoor push button. Ensure you have turned the power back on and the receiver is turned on.
- Your wired doorbell should ding as normal & your LRA receiver should respond per its settings.
- Place the transmitter in the desired location & affix it using the double-sided tape or mounting screws.

## Low Battery Indicator

A randomly blinking zone light on the LRA-DCRX receiver (or a red LED in the LRA-DCRXS) indicates that the battery is low for this transmitter. receiver. Please replace the battery as soon as possible.

If the strobe light on the LRA-DCRX seems to randomly flash, it means the batteries in the receiver are weak and needs to be replaced.

## TECHNICAL SUPPORT

If you encounter any difficulty in the operation of this product after reading the manual, please contact us. You can reach us by phone at 904-245-1184 from 8:00 AM to 5:00 PM Monday through Friday (Eastern Standard Time). We will be happy to answer your questions and help you in any way we can.

## WARRANTY

*Safeguard Supply warrants this product to be free of defects in material and workmanship for a period of one year from the date of purchase. This warranty does not cover damage resulting from accident, abuse, act of God or improper operation. If this product does become defective, simply return it to Safeguard Supply. Please include a note describing the troubles along with your name and return address as well as the original sales receipt. If the product is covered under warranty it will be repaired or replaced at no charge. If it is not covered by warranty, you will be notified of any charges before work is done.*

**Safeguard Supply**  
2260 Moon Station Ct. NW #110  
Kennesaw, GA 30144  
[www.safeguardsupply.com](http://www.safeguardsupply.com)



**WARNING:** Cancer and Reproductive Harm. Go to [www.P65Warnings.ca.gov](http://www.P65Warnings.ca.gov) for more information.